

HYUNDAI
POWER PRODUCTS

PETROL LOG SAW

HSBT7672

ORIGINAL INSTRUCTIONS

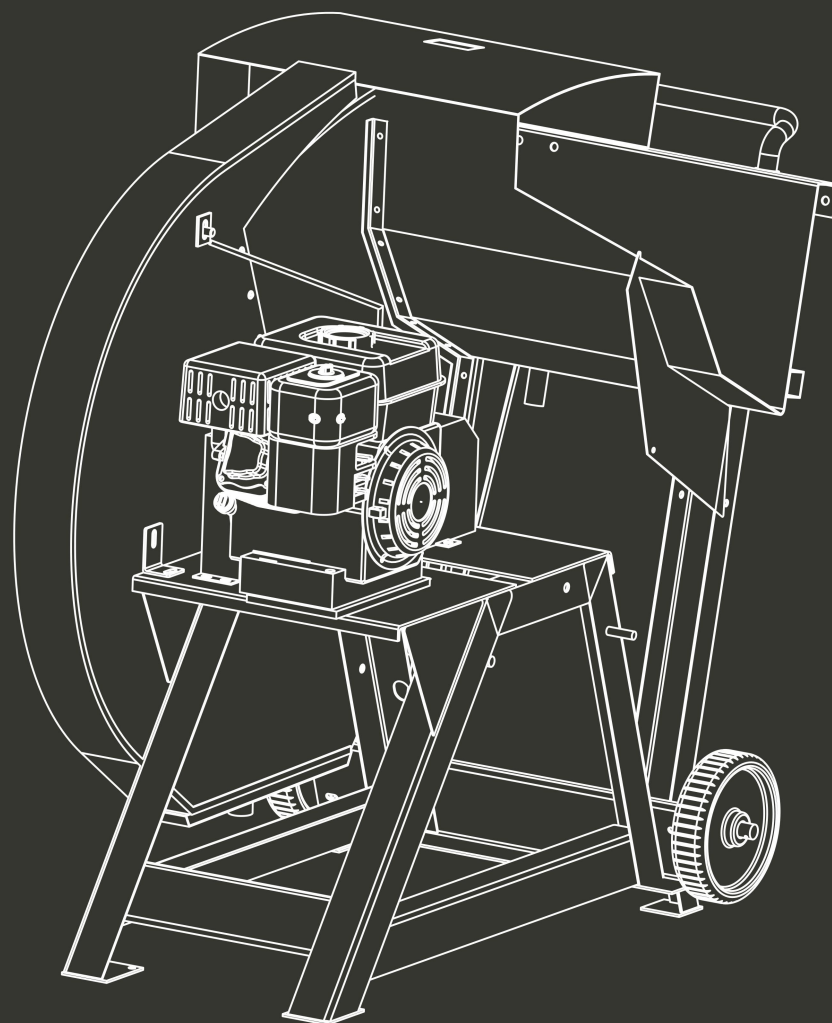

CONTENTS

| | |
|-------------------------------------|-----------|
| 1. SAFETY WARNINGS | 3 |
| 2. PRODUCT VIEW | 13 |
| 3. ASSEMBLY | 13 |
| 4. USE | 15 |
| 5. MAINTENANCE | 19 |
| 6. STORAGE | 22 |
| 7. DECLARATION OF CONFORMITY | 23 |

1. SAFETY WARNINGS

When using this machine observe the following safety instructions, to exclude the risk of personal injury or material damage.

Please also observe the special safety instructions in the respective chapters; where applicable, follow the legal directives or regulations for the prevention of accidents pertaining to the use of circular saw.



General hazards!

1. Be alert. Know what you are doing. Set out to work with reason. Do not operate machine while under the influence of drugs, alcohol or medication.
2. Keep your work area tidy – a messy work area invites accidents.
3. Regularly clear the work area of the cut logs.
4. Prevent adverse body positions. Ensure firm footing and keep your balance at all times.
5. Consider environmental effects:

Provide proper lighting.

Do not operate machine near inflammable liquids or gases.

This machine shall only be started and operated by a person familiar with circular saw and who is at all times aware of the dangers associated with the use of such machine.

Keep bystanders, particularly children, out of the danger zone. Persons under 18 years of age shall use this machine only in the course of their vocational training, under the supervision of an instructor.

Do not permit other persons to touch the machine while it is running.

6. During operation the machine is standing on level, horizontal ground and that the floor area around the machine is level, well maintained and free from loose material e.g. chips and off-cuts.
7. Stock and finished workpieces to be located close to the operators normal working position.
8. The wear of suitable personal protective equipment when necessary; This may include:
 - Hearing protection to reduce the risk of induced hearing loss;
 - Respiratory protection to reduce the risk of inhalation of harmful dust;
 - Gloves for handling saw blades (saw blades should be carried in a holder wherever practicable).
9. Stop the machine running whilst unattended.

10. Report faults in the machine, including guards or saw blades, as soon as they are discovered.
11. Adopt safe procedures for cleaning, maintenance and remove chips and dust regularly to avoid the risk of fire.
12. Follow manufacturer's instructions for use, adjustment and repair of saw blades.
13. Observe the maximum speed marked on the saw blade.
14. To use correctly sharpened saw blades.
15. Refrain from removing any off-cut or other part of the workpiece from the cutting area whilst the machine is running except by using a push stick.
16. Use the saw blades designed to reduce the emitted noise.
17. Ensure that guards and other safety devices necessary for machine operation are in position, in good working order and properly maintained.
18. The saw blade made in conformity to EN847-1: 2013 shall be used on the machine.
19. Never dismantle the machine's safety devices or render them inoperative.
20. To rectify faults or remove jammed pieces of wood, always switch off the machine first. Stop the engine!
21. Refit all guards and safety devices immediately after you have completed any repairs or maintenance work.
22. Make sure you stand squarely and keep your balance at all times.
23. Each time before re-using the tool, carefully check that the guards or parts are working as intended.
24. Check that the moving parts are in good working order, that they do not jam, and that no parts are damaged. Make sure that all parts are fitted correctly and that all other operating conditions are properly fulfilled.
25. Have damaged switches replaced by a customer service workshop.
26. Use only the transport devices to move the machine. Never use the guards for handling and moving the machine.
27. All operators must receive proper training in the use, adjustment and operation of the machine.
28. Make sure that the flanges used are as specified by the manufacturer , suitable for the intended use .

29. Make sure you include that necessary for operating the machine guards and other safety devices are fitted, they are in good operating condition and properly maintained.

30. Do not use circular saw blades made of high-alloy high-speed steel



Risk of personal injury and crushing by moving parts!

Do not operate the machine without installed guard.

Keep sufficient distance to driven components when operating the machine.

Ensure the engine stopped before servicing.

Ensure that when switching on (e.g. after servicing) no tools or loose parts are left on or in the machine.

Stop the engine if the machine is not used.



Hazard generated by modification of the machine or use of parts not tested and approved by the equipment manufacturer!

Use only parts approved by the equipment manufacturer. This applies particularly to :

- Saw blade (see "Technical specifications")
- Engine (type: JF390)

Do not change any parts.



Hazard generated by machine defects!

Keep machine and accessories in good repair. Observe the maintenance instructions.

Before any use check machine for possible damage: before operating the machine all safety devices, protective guards or slightly damaged parts need to be checked for proper function as specified. Checked to see that all moving parts work properly and do not jam. All parts must be correctly installed and meet all conditions necessary for the proper operation of the machine.

Damaged protection devices or parts must be repaired or replaced by a qualified specialist. Have damaged switches replaced by a service center. Keep handles free of oil, grease and resin.



Hazard generated by dust

Pay attention to the factors that influence exposure to dust, this includes:

- Type of material being machined

- Importance of local extraction (capture at source)
- Proper adjustment of hood / baffles / chutes

A: The machine should be checked whether inner and outer blade cover, left and right side table moving cover, inner and outer flange of blade and blade are proper before operation.

B: Pushing the moving worktable forward and check whether left and right table moving cover and inner and outer blade touch each other so as to avoid unnecessary damage, while the log saw is working **after engine starting**.

SPECIAL SAFETY WARNINGS

Observe the permissible dimensions of logs to be cut (see “Technical Specifications”).

Never cut several workpieces at the same time – and also no bundles containing several individual pieces. Risk of personal injury if individual pieces are caught by the saw blade uncontrolled. Never cut log containing the following:

- ropes
- cords
- cables
- wires

Do not overload machine – use it only within the performance range it was designed for (see “Technical specifications”).

Use this machine outdoor only.

- It must be guaranteed that, during its entire service life, the machine, including its components, cannot overturn, fall or move in an uncontrolled manner, whether during transport, assembly, disassembly, deactivation and disposal. The machine must always remain on a stable flat surface, transport safely with the protection on the blade and the protections must always be in good working order.
- Please stop the engine after use, cleaning the machine, and store it in a dry and ventilated place.
- During use, the surfaces and protections (if supplied) may be hot. Avoid contact with these surfaces and wear protective gloves.
- In the event of an accident or breakdown, stop using the machine and switch it off. Check the machine; if repairs are necessary, they must be carried out by a qualified service.

ENGINE SAFETY

- The engine are designed for safe and reliable operation, provided the instructions for use are followed. Read and understand the operating instructions before operating the engine. Failure to

do so could result in injury or equipment damage.

- Keep the engine at least 1 meter (3 feet) away from buildings and other equipment during operation to avoid fire hazard and to provide adequate ventilation. Do not place flammable objects near the engine.
- Children and pets must be kept away from the area of operation due to the possibility of injury from contact with hot engine parts or any components that operate the engine
- Know how to stop the engine quickly and how all the controls work.

Do not let anyone operate the engine without proper instructions.

- Gasoline is extremely flammable and is also explosive under certain conditions.
- Refuel in a well-ventilated area with the engine turned off.

Do not smoke and do not allow flames or sparks in the fueling area or in the petrol storage location.

- Do not overfill the fuel tank. Make sure that the fuel cap after refueling is closed correctly and securely.
- Be careful not to spill fuel when refueling. Fuel vapor or spilled fuel can ignite. Make sure the operating area is dry before starting the engine if fuel is spilled beforehand.
- Never run the engine in a narrow or closed area. Exhaust gases included toxic carbon monoxide; Contact with the toxic exhaust gases can lead to unconsciousness and death.
- The muffler will be very hot during operation and will remain hot for a while after the engine has stopped. Be careful not to touch the muffler when it is still hot. To avoid serious burns or the risk of fire, allow the engine to cool down before transporting it or storing it indoors.

Warning! The setting parameters must not be modified.

Warning! Exhaust gas, fuel and lubricant are toxic.

The installation and repair of the engine may only be carried out by trained personnel.

SAFE WORKING PRACTICE

It is essential all operators are:

- Adequately trained in the use, adjustment and operation of the machine;
- Instructed in factors that influence exposure to noise e.g.:
 - saw blade designed to reduce the emitted noise;

- saw blade and machine maintenance.
- Informed of factors that influence exposure to dust e.g.:
 - type of material being machined;
 - importance of local extraction(capture at source);
 - proper adjustment of hoods/baffles/chutes;
 - where provided, dust extraction equipment to be switched on before commencing machining.

It is important that:

- During operation the machine is standing on level, horizontal ground and that the floor area around the machine is level, well maintained and free from loose material e.g. chips and off-cuts;
- Adequate general or localized lighting is provided;
- Stock and finished workpieces are located close to the operator's normal working position.

It is essential for the operator to:

- Use a push block or push stick to avoid working with the hands close to the saw blade when using a dual purpose circular sawing machine for firewood/circular saw bench in the saw bench mode;
- Wear suitable personal protective equipment when necessary; this could include;
 - hearing protection to reduce the risk of induced hearing loss;
 - respiratory protection to reduce the risk of inhalation of harmful dust;
 - gloves for handling saw blades (saw blades should be carried in a holder wherever practicable);
- Refrain from cross cutting logs on a machine in the saw bench mode;
- Stop the machine running whilst unattended;
- report faults in the machine, including guards or saw blades, as soon as they are discovered;
- Adopt safe procedures for cleaning, maintenance and remove chips and dust regularly to avoid the risk of fire;
- follow manufacturers instruction for use, adjustment and repair of saw blades;
- Select the correct riving knife, depending on the saw blade thickness, when using a dual purpose circular sawing machine for firewood/circular saw bench in the saw bench mode;

- Observe the maximum speed marked on the saw blades;
- Use correctly sharpened saw blades;
- Ensure that any spacers and spindle rings used are suitable for the purpose as stated by the manufacturer;
- refrain from removing any off-cut or other part of the workpiece from the cutting area whilst the machine is running except by using a push stick;
- Ensure that guards and other safety devices necessary machine operation are in position, in good working order and properly maintained.

When used indoors, the machine must be connected to an external chip and dust extraction system.

RESIDUAL RISK

The following risks are inherent to the use of these machines:

- Injuries caused by touching the rotating parts
- Injuries caused by disruption of the cutting blade

These risks are most evident:

- Within the range of operation
- Within the range of the rotating machine parts

In spite of the application of the relevant safety regulations and the implementation of safety devices, certain residual risks cannot be avoided. These are:

- Impairment of hearing.
- Risk of accidents caused by the uncovered parts of the rotating cutting blade.
- Risk of injury when changing the blade.
- Risk of squeezing fingers when opening the guards.

- Braking should be verified every before use, running the machine, [stop the engine](#), then check the stopping time.
- Only saw blades made in conformity to EN 847-1:1997 shall be used on the machine;
- The machine during indoor use shall be connected to an external chip and dust extraction system;

DESCRIPTION OF THE SYMBOLS

The use of symbols in this manual is intended to draw your attention to possible risks. The safety symbols and the explanations that accompany them must be perfectly understood. The warnings in themselves do not remove the risks and cannot replace correct actions for preventing accidents.



Read the operator's manual.

Before any use, refer to the corresponding paragraph in the present manual.



This symbol, before a safety comment, indicates a precaution, a warning or a danger. Ignoring this warning can lead to an accident for yourself or for others. To limit the risk of injury, fire, or electrocution always apply the recommendations indicated.



Wear ear protection, eye protection, helmet, mask, non-skid footwear, gloves and face protection



Saw blade for cutting wood.



Do not use for face grinding.



Do not use in the rain or leave outdoors while it's raining.



Keep your hands away from blade and cracks which open in the log;



Keep children away.



The unit must be always operated by one person only. Other people should keep a safe distance from the work area, especially when the log saw is under operations. Never use another people to help you with freeing jammed log.

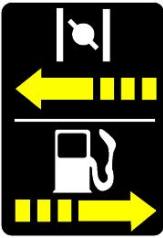

Choke lever & Fuel valve level

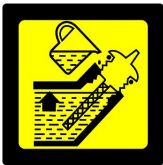

Add Engine oil.



Conforms to European standards



The crossed-out wheeled bin symbol indicates that the item should be disposed of separately from household waste. The item should be handed in for recycling in accordance with local environmental regulations for waste disposal. By separating a marked item from household waste, you will help reduce the volume of waste sent to incinerators or land-fill and minimize any potential negative impact on human health and the environment.

INTENDED USE

This machine is only intended for cutting firewood as detailed in these instructions. Unspecified use, modifications to the machine, or use of parts not tested and approved by the equipment manufacturer may cause unforeseeable damage!

This machine is intended for operation by ONE person. Other persons shall keep a sufficient distance to the machine.

TECHNICAL SPECIFICATIONS

| | |
|----------------------------------|-----------------------------|
| Engine power(4-cycle) | 7600W/3200min ⁻¹ |
| Engine displacement | 389cm ³ |
| Fuel tank capacity: | 1.1 L |
| Engine oil tank capacity: | 6.5 L |
| Saw blade | Ø700mm x Ø30mm x 3mm x 42T |
| Cutter Capacity | Ø30-230mm |
| Machine weight | 133kg |
| Sound pressure level LpA: | 91 dB(A) K=2 dB(A) |
| Sound power level LwA: | 106 dB(A) K=2 dB(A) |

Measured sound values determined according to EN ISO 3744

The noise figures quoted are emission levels and are not necessarily safe working levels. Whilst there is a correlation between the emission and exposure levels, this cannot be used reliably to determine whether or not further precautions are required. Factors that influence the actual level of exposure of work-force include the characteristics of the work room, the other sources of noise, etc. i.e. the number of machines and other adjacent processes, and the length of time for which an operator is exposed to the noise. Also the permissible exposure level can vary from country. This information, however, will enable the user of the machine to make a better evaluation of the hazard and risk.

Wear hearing protection!

Pay attention to the factors that influence exposure to noise, this includes:

- Use saws blades designed to reduce the emitted noise
- Maintain saw blade and the machine properly

2. PRODUCT VIEW

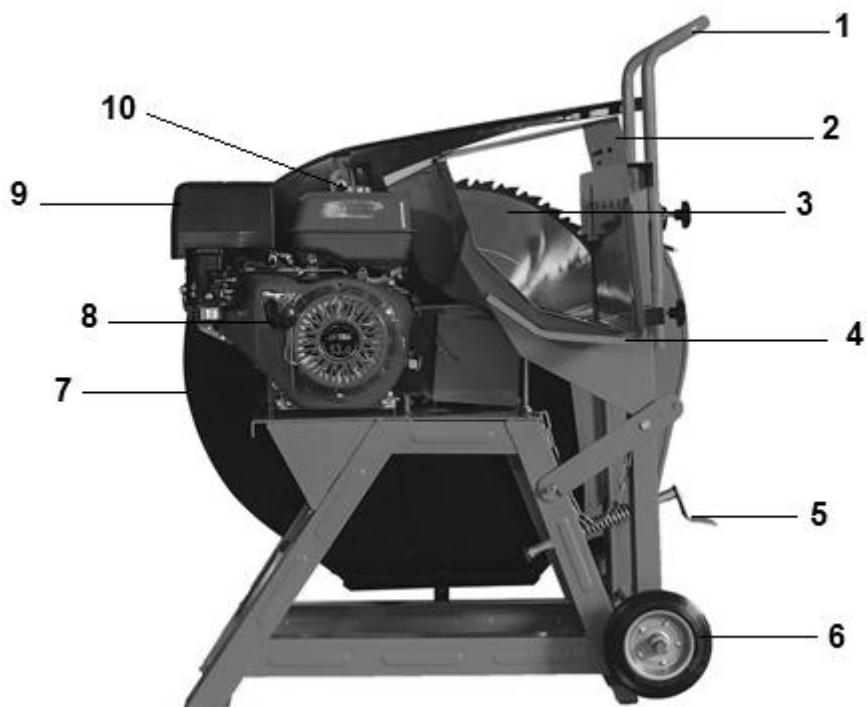

1. Handle
2. Protective cover
3. Saw
4. Sliding support
5. Spring hose
6. Wheel
7. Saw protection guard
8. Starter rope
9. Air filter
10. Fuel tank

3. ASSEMBLY

NOTE: This machine is delivered already assembled. If parts of the machine are not assembled upon delivery, please follow the instructions below. If there is a problem with the assembly, contact our customer service.

It is recommended that the machine is assembled by 2 people.

a. Protective cover

Pass the protective cover over the work table. Put the tabs in the two holes on the work table. Tighten the tab screws to secure the cover securely on the work table.

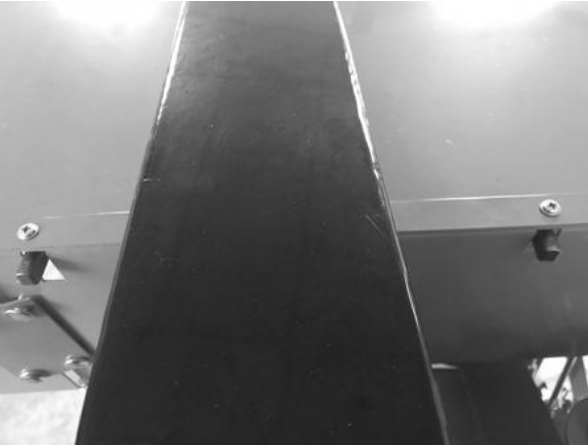

b. Pendulum handle

Unscrew the knobs. Insert the handle tubes into the supports on the back of the log holder. Adjust the handle to the desired height then lock it with the knobs.



c. Sliding support

Unscrew the nut screw. Insert the sliding support into the hole in the tool. Screw with the screw nut to lock it.



To adjust the position of the sliding support, unscrew the nut screw and then change the position of the sliding support. Lock the support with the nut screw.

d. Connection plate

Assemble the connection plate to the work table by inserting the screws in the appropriate holes. Tighten with the bolts.



4. USE

BEFORE STARTING

Check and fill engine with approximately 1.1 litres SAE10W-30 oil. Fill the fuel tank with 93+octane unleaded gasoline

STARTING THE ENGINE

1. Move the fuel valve lever to the ON position.

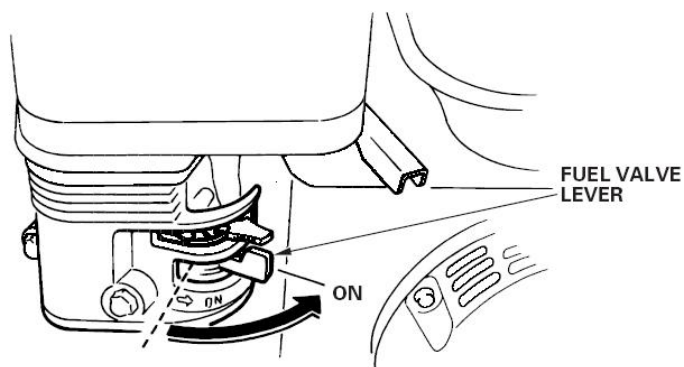

2. To start a cold engine, move the choke lever to the CLOSED position.

To restart a warm engine, leave the choke lever in the OPEN position.

Some engine applications use a remotely-mounted choke control rather than the

engine-mounted choke lever shown here.

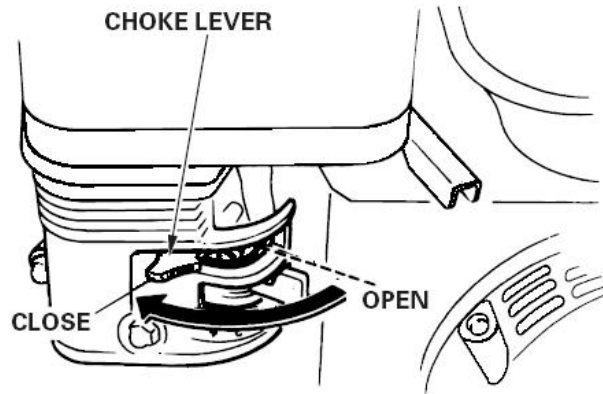

3. Move the throttle lever away from the SLOW position, about 1/3 of the way toward the FAST position.

Some engine applications use a remotely-mounted throttle control rather than the engine-mounted throttle lever shown here.

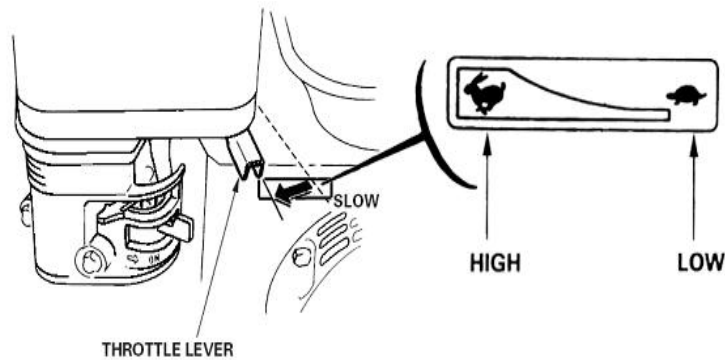

4. Turn the engine switch to the ON position.

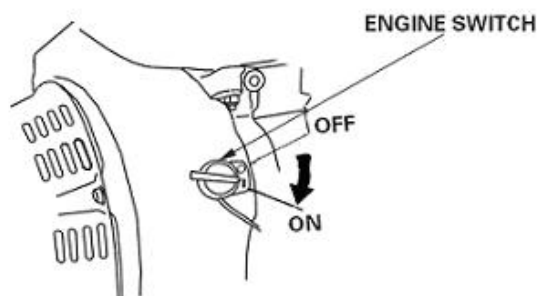

5. Operate the starter.

RECOIL STARTER

Pull the starter grip lightly until you feel resistance, then pull briskly.

Return the starter grip gently.

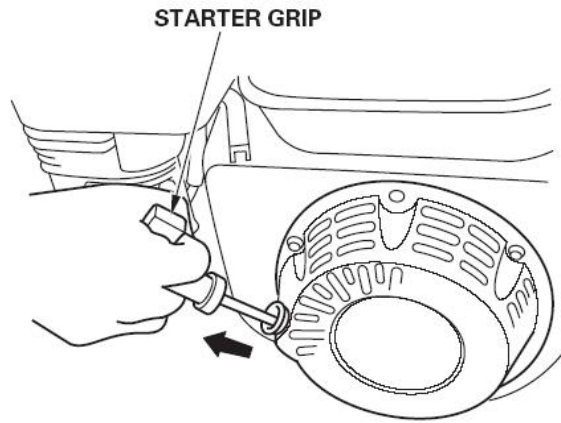

6. If the choke lever has been moved to the CLOSED position to start the engine, gradually move it to the OPEN position as the engine warms up.

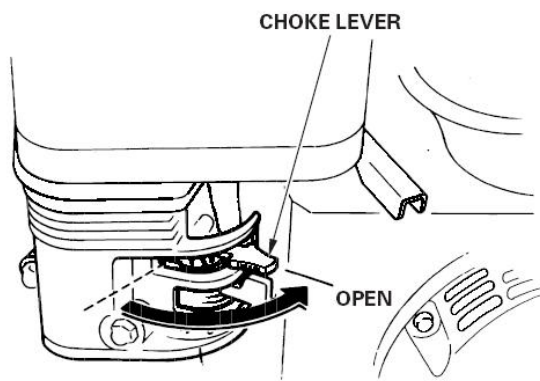

STOPPING THE ENGINE

To stop the engine in an emergency, simply turn the engine switch to the OFF position. Under normal conditions, use the following procedure.

1. Move the throttle lever to the SLOW position.

Some engine applications use a remotely-mounted throttle control rather than the engine-mounted throttle lever shown here.

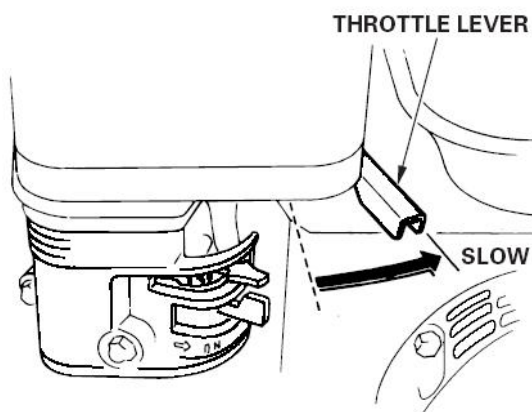

2. Turn the engine switch to the OFF position.

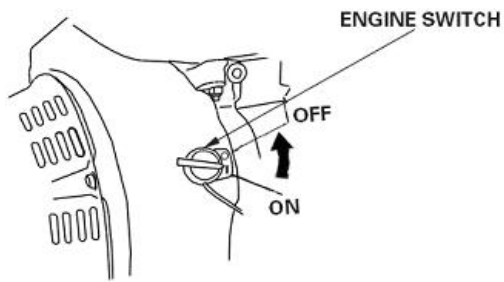

3. Turn the fuel valve lever to the OFF position.

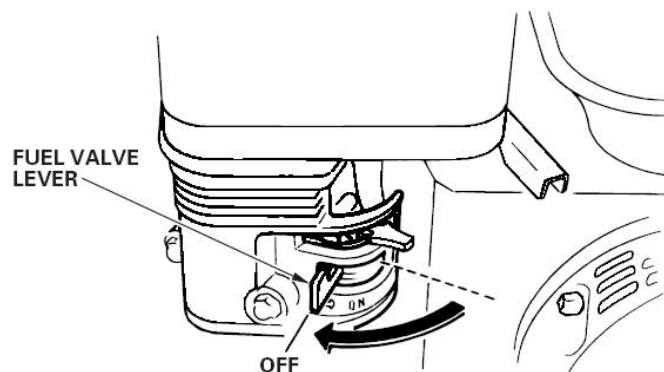

OPERATION

Sawing

1. Open the machine by removing the safety bar at the bottom of the machine.
2. Turn on the machine.
3. Wait until the saw blade has reached its maximum speed.
4. Place the wood on the rocker by using the pusher.
5. Grasp the balance handlebar with both hands and push it towards the blade.
6. Push the rocker with evenly so that the engine speed does not drop.
7. Remove the sawn wood from the scale before installing the next piece.
8. When finished, turn off the machine and wait for the blade to stop completely. Put back the safety bar.

Safe removal of possible blocking

Switch off the machine and remove the spark plug.

Check it and localize the blocking.

Remove the blocking while considering all safety instructions.

Check the machine visually and make sure it is not damaged. In particular, the saw blade must not show any sign of damage.

5. MAINTENANCE

- **Warning:** Turn off the machine and disconnect from the power supply before conducting maintenance work or settings.
- **Wear goggles when cleaning the machine.**
- Handle your device carefully and out of reach of the children.
- Have your tool repaired by a qualified person. This power tool complies with the applicable safety standards. Repairs should be performed only by qualified persons using original spare parts, otherwise this may make the use extremely dangerous.
- Use only the blade recommended by the manufacturer for this model. If a blade is damaged, it must only be repaired by the manufacturer or qualified persons.
- Use only well-sharpened, crack-free and not distorted blades.
- Use only blades that comply with the European standard EN 847-1.
- Ensure that there are no tools or other materials on or in the machine before putting it into operation.
- Exchange immediately rocker that run out.
- The braking must be checked before and after each use. To check the braking, run the machine, stop the engine, and check the downtime.

Before and after each use

- Check the blade
- Make the air vents are never obstructed by debris or accumulation of other objects, as this may damage the engine or cause a fire risk.
- Clean your tool, using a damp cloth and a soft brush. Never clean the product with water and never immerse it in liquid. Never use solvents or detergents as this may damage the plastic parts of the product.
 - Check all safety
 - Remove possible sawdust blockages at the discharge.

Every 50 hours of operation

- Check all screwed connections, tighten if necessary (Rocker and rocker stop must remain movable)

Saw blade change



Directly after cutting the saw blade can be very hot – burning hazard! Let a hot saw blade cool down. Do not clean the saw blade with combustible liquids. Risk of injury, even with the blade at standstill. Wear gloves when changing blades.

When assembling, observe the direction of rotation of saw blade!

Be careful of the pendulum when disassembling the saw! Hold it firmly in order to avoid accidents and serious injuries. It is recommended to be 2 people for the blade changing.

1. Remove the protection bar.
2. Unscrew the hook which is on the base of the tool.
3. Unscrew the screw which is on the spring hose
4. Unscrew the screw which is on the right blade guard.
5. Hold the tool by the handle, and bring down the pendulum.

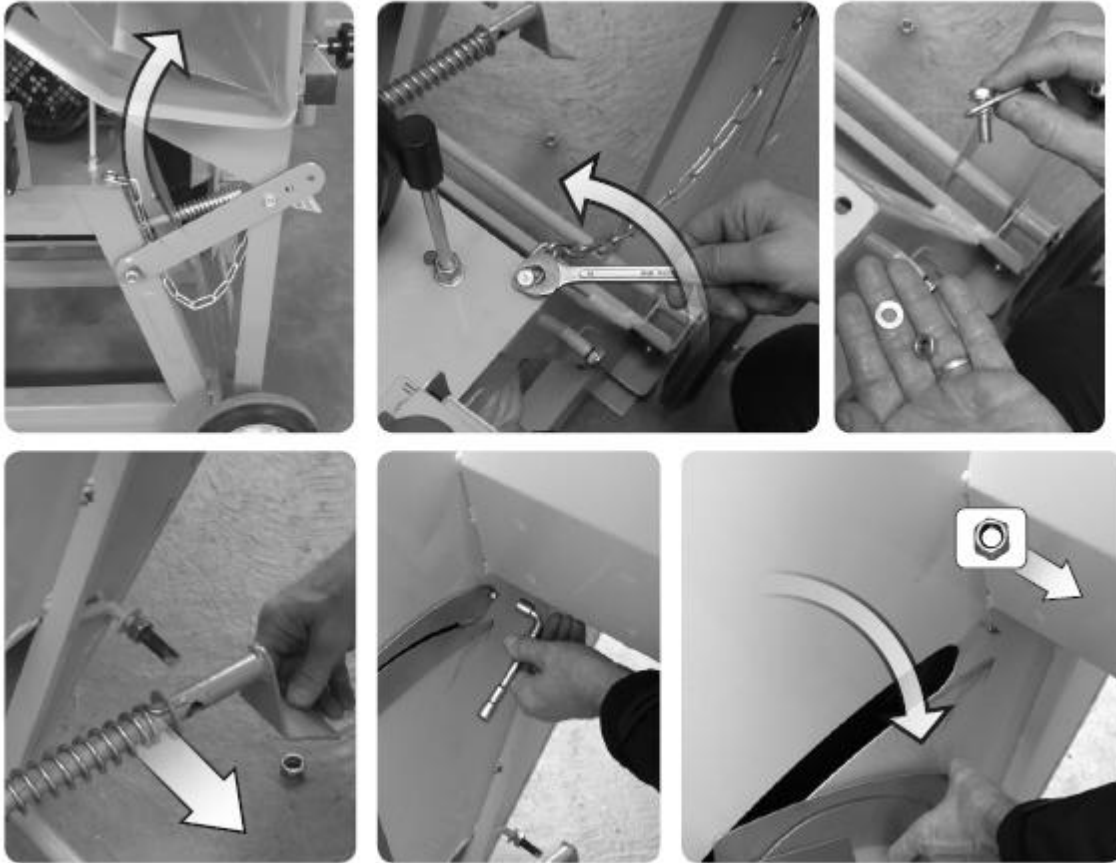

6. Remove the nut and outer flange from the saw spindle. Take the saw blade off the saw spindle.

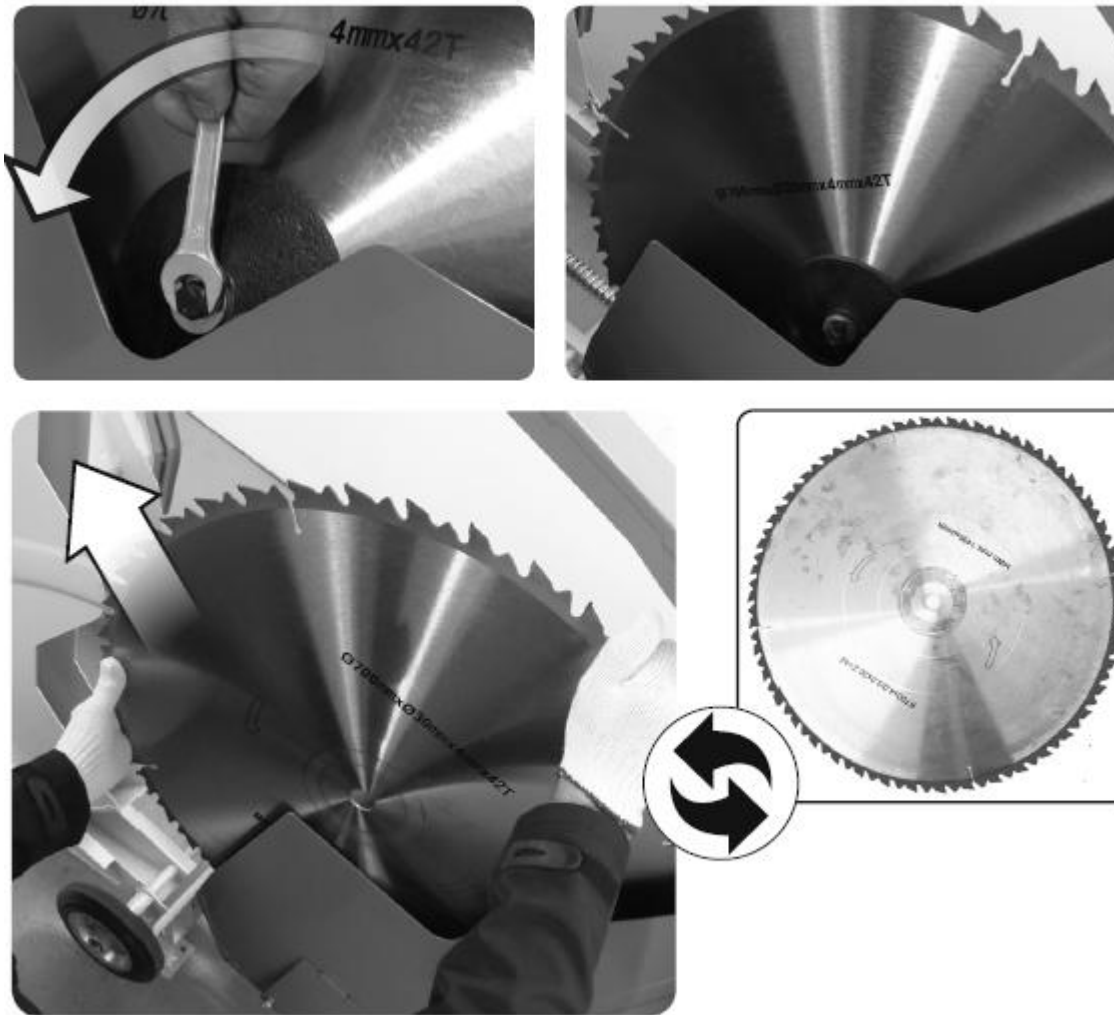

7. Clean clamping surfaces of :

- saw spindle,
- Inner flange,
- saw blade,
- Outer blade flange,
- Nut.

⚠ Danger!

Do not use cleaning agents (e.g. to remove resin residue) which could corrode the light alloy components; this can have an adverse effect on the machine's stability.

Do not clean the saw blade with combustible liquids.

8. Install new saw blade, observing the direction of rotation. Put back the machine in place.



Danger!

Use only saw blades conforming to the technical specifications and EN 847-1 – parts of unsuitable or damaged saw blades may be hurled away explosive-like.

Do not use:

- saw blades made of high speed steel (HS or HSS);
- saw blades with visible damage;
- cut-off wheel blades.

Saw storage



Danger!

Store saw so that

- It cannot be started by unauthorized persons, and nobody can get injured.



Caution!

Do not store saw unprotected outdoors or in damp environment.



Note:

Always install the transport brace before transporting the saw.

To keep the saw blade from rusting, spray with Cleaning and Maintenance Spray (optional accessory) before storing it for a longer time.

Every 50 hours of operation

Check all screwed connections, tighten if necessary (Rocker and rocker stop must remain movable).

Check saw blade for firm seat, wear and sharpness.

Remove any deposits that may have build up inside the saw blade cover.

Draining

The first emptying must be done after 10h or 1 year after the first use. This operation must be carried out by a qualified service.

Air filter

Remove the cover, remove the foam element and wash it with petrol. Let it dry well in the sun. Saturate it with engine oil then press it firmly to distribute the oil evenly and remove the excess. Reinsert it into its housing, respecting the mounting direction.

Remove the tank and empty it into a suitable container. Wash it with liquid detergent and water then dry it. Reassemble by putting new SAE 10W30 engine oil in the filter bowl. The filling level is indicated on the tank.

Change the oil in the air filter every 25 hours or once a year. Clean the filter regularly, especially in a dusty atmosphere.

For more explanations, refer to the engine manual or ask your dealer for advice.

6. STORAGE

- Store the manual close to the machine.
- Always wait the appliance cool down before storage.
- Always store the log saw in a dry area.
- Wipe the log saw clean with a brush. Apply a thin layer of oil using an oily cloth to protect the machine from rust, before storage.

7. DECLARATION OF CONFORMITY EC



EC Conformity declaration

BUILDER SAS

ZI, 32 rue Aristide Bergès – 31270 Cugnaux - France

Tel: +33 (0)5.34.502.502 Fax: +33 (0)5.34.502.503

The undersigned, hereby certifies that the units described below

PETROL LOG SAW

Model: HSBT7672

S/N: [20240604515-20240604517](#)

is in compliance with the provisions of the following European directives:

2014/30/EU " Electromagnetic Compatibility ",

2006/42/EC "Machinery",

2011/65/EU "ROHS"

Emissions Directive 2016/1628/EU

And to the following standards:

EN 1870-6:2017

EN ISO 12100:2010

EN ISO 14982: 2009

EC-type certificate number: **No. M6A 058058 0432 Rev. 01**

Notified Body: No 0123

TÜV SÜD Product Service GmbH · Zertifizierstelle · Ridlerstraße 65 · 80339 München · Germany

The people name holding the technical file: Mr. Olivier Patriarca

Cugnaux, 05/05/2024

Philippe MARIE / PDG

8. WARRANTY

HYUNDAI

WARRANTY

The manufacturer guarantees the product against defects in material and workmanship for a period of 2 years from the date of the original purchase. The warranty only applies if the product is for household use. The warranty does not cover breakdowns due to normal wear and tear.

The manufacturer agrees to replace parts identified as defective by the designated distributor. The manufacturer does not accept responsibility for the replacement of the machine, in whole or in part, and/or ensuing damage.

The warranty does not cover breakdowns due to:

- insufficient maintenance.
- abnormal assembly, adjustment or operations of the product.
- parts subject to normal wear and tear.

The warranty does not extend to:

- shipping and packaging costs.
- using the tool for a purpose other than that for which it was designed.
- the use and maintenance of the machine done in a manner not described in the user manual.

Due to our policy of continuous product improvement, we reserve the right to alter or change specifications without notice. Consequently, the product may be different from the information contained therein, but a modification will be undertaken without notice if it is recognized as an improvement of the preceding characteristic.

READ THE MANUAL CAREFULLY BEFORE USING THE MACHINE.

When ordering spare parts, please indicate the part number or code, you can find this in the spare parts list in this manual. Keep the purchase receipt; without it, the warranty is invalid. To help you with your product, we invite you to contact us by phone or via our website:

- **+33 (0)9.70.75.30.30**
- **<https://services.swap-europe.com/contact>**

You must create a "ticket" via the web platform.

- Register or create your account.
- Indicate the reference of the tool.
- Choose the subject of your request.
- Describe your problem.
- Attach these files: invoice or sales receipt, photo of the identification plate (serial number), photo of the part you need (for example: pins on the transformer plug which are broken).



9. PRODUCT FAILURE

WHAT TO DO IF MY MACHINE BREAKS DOWN?

If you bought your product in a store:

- a) Empty the fuel tank if your product has one.
- b) Make sure that your machine is complete with all accessories supplied, and clean! If this is not the case, the repairer will refuse the machine.

Go to the store with the complete machine and with the receipt or invoice.

If you bought your product on a website:

- a) Empty the fuel tank if your product has one..
- b) Make sure that your machine is complete with all accessories supplied, and clean! If this is not the case, the repairer will refuse the machine.
- c) Create a SWAP-Europe service ticket on the site: <https://services.swap-europe.com> When making the request on SWAP-Europe, you must attach the invoice and the photo of the nameplate (serial number).
- d) Contact the repair station to make sure it is available before dropping off the machine.

Go to the repair station with the complete machine packed, accompanied by the purchase invoice and the station support sheet downloadable after the service request is completed on the SWAP-Europe site

For machines with engine failure from manufacturers BRIGGS & STRATTON, HONDA and RATO, please refer to the following instructions.

Repairs will be done by approved engine manufacturers of these manufacturers, see their site:

- <http://www.briggsandstratton.com/eu/fr>
- <http://www.honda-engines-eu.com/fr/service-network-page;jsessionid=5EE8456CF39CD572AA2AEEDFD290CDAE>
- <https://www.rato-europe.com/it/service-network>

Please keep your original packaging to allow for after-sales service returns or pack your machine with a similar cardboard box of the same dimensions.

For any question concerning our after-sales service you can make a request on our website <https://services.swap-europe.com>

Our hotline remains available at +33 (9) 70 75 30 30.



10. WARRANTY EXCLUSIONS

THE WARRANTY DOES NOT COVER:

- Start-up and setting up of the product.
- Damage resulting from normal wear and tear of the product.
- Damage resulting from improper use of the product.
- Damage resulting from assembly or start-up not in accordance with the user manual.
- Breakdowns related to carburetion beyond 90 days and fouling of carburetors.
- Periodic and standard maintenance events.
- Actions of modification and dismantling that directly void the warranty.
- Products whose original authentication marking (brand, serial number) has been degraded, altered or withdrawn.
- Replacement of consumables.
- The use of non-original parts.
- Breakage of parts following impacts or projections.
- Accessories breakdowns.
- Defects and their consequences linked to any external cause.
- Loss of components and loss due to insufficient screwing.
- Cutting components and any damage related to the loosening of parts.
- Overload or overheating.
- Poor power supply quality: faulty voltage, voltage error, etc.
- Damages resulting from the deprivation of enjoyment of the product during the time necessary for repairs and more generally the costs related to the immobilization of the product.
- The costs of a second opinion established by a third party following an estimate by a SWAP-Europe repair station
- The use of a product which would show a defect or a breakage which was not the subject of an immediate report and/or repair with the services of SWAP-Europe.
- Deterioration linked to transport and storage*.
- Launchers beyond 90 days.
- Oil, petrol, grease.
- Damages related to the use of non-compliant fuels or lubricants.

* In accordance with transport legislation, damage related to transport must be declared to carriers within 48 hours maximum after observation by registered letter with acknowledgement of receipt.

This document is a supplement to your notice, a non-exhaustive list.

Attention: all orders must be checked in the presence of the delivery person. In case of refusal by the delivery person, it you must simply refuse the delivery and notify your refusal.

Reminder: the reserves do not exclude the notification by registered letter with acknowledgement within 72 hours.

Information: Thermal devices must be wintered each season (service available on the SWAP-Europe site). Batteries must be charged before being stored.

HYUNDAI
POWER PRODUCTS



GENUINE PRODUCT OF
HYUNDAI CORPORATION

For inquiries, please contact:

BUILDER SAS

32 rue Aristide Bergès - Z.I. du Casque - 31270 Cugnaux - France

Tél.: +33(0)5.34.502.502 Fax.: +33(0)5.34.502.503

<http://www.hyundaipower-fr.com/>

Fabriqué en République Populaire de Chine(PRC)

Importée par BUILDER SAS, France

Licensed by Hyundai Corporation Holdings, Korea